

Singlemode ST/ST simplex adapter, Metal housing argent, ceramic sleeve, blue dust cap,



Specification

ITEM	Adaptors
Sleeve Material	Ceramic
Typical Insertion Loss, dB	0.1
Max Insertion Loss, dB	0.2
Operating Temperature, °C	-40 ~ +75
Storage Temperature, °C	-55 ~ +85

Mechanical Diagram

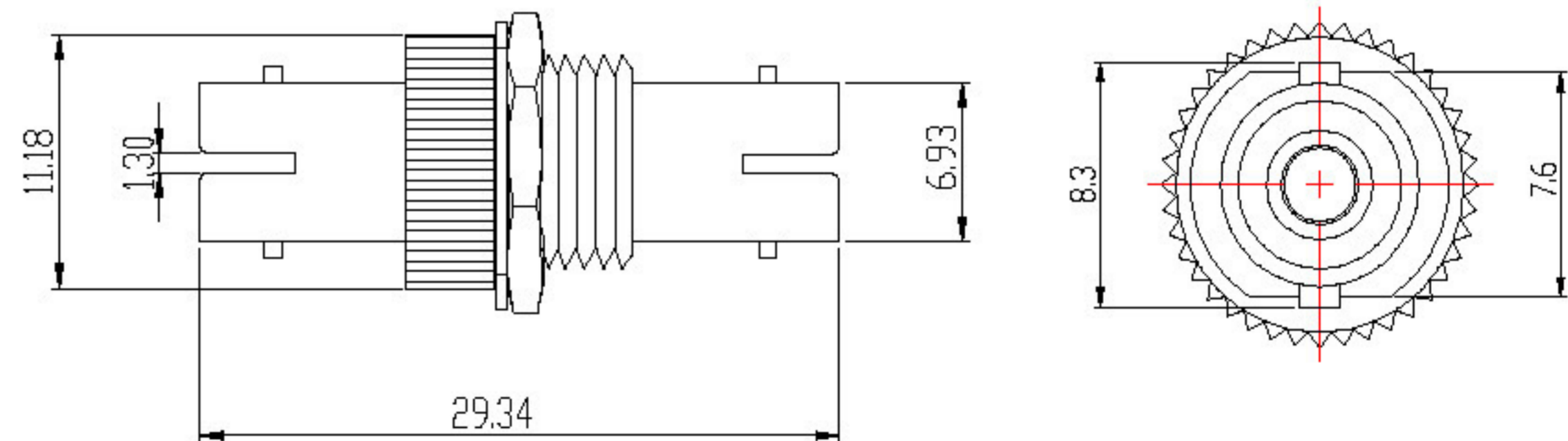

EA 1001

The performance of the adaptors has been carefully designed to meet the toughest Telcordia standards

GR-326-CORE

in the tests of:

- OPTICAL CHARACTERISTICS
- VIBRATION TEST
- THERMAL CYCLING
- IMPACT RESISTANCE
- SALT SPRAY EROSION
- THERMAL AGING
- HUMIDITY RESISTANCE
- OTHERS